

# Electrical Linkages

## Electrical Linkages

### - Push Pull Connectors

#### Introduction

#### Features

Series PS Push Pull Connectors are ideally suitable for application in high value equipment finding outdoor applications, amongst others.

- ▶ Watertight when giving protection index of IP 66
- ▶ No disconnection under vibration or pull against cable
- ▶ Self locking, screw free design; Push to connect: Pull to disconnect
- ▶ High temperature range (-180°C to 1200°C)
- ▶ Female contacts of closed entry design ensuring perfect concentric mating
- ▶ Low contact resistance
- ▶ High voltage, low voltage and/ or mixed voltage ratings
- ▶ Secure and reliable electrical connections

#### Standard Materials:

Body            Brass, chrome plated  
 Insulator      PTFE  
 Contacts        Copper Alloy, silver plated

#### Specifications:

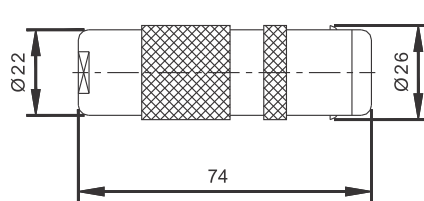

PLUG

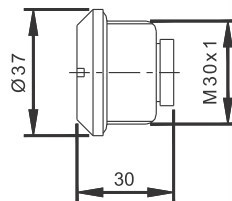

SOCKET



CONTACT ARRANGEMENT						
NO. OF CONTACTS	2	3	4	5	6	
WORKING VOLTAGE (KV)	C - C	5.0	3.0	3.0	0.7	0.7
	B - C	5.0	3.0	3.0	0.8	0.8
PROOF VOLTAGE (KV)	C - C	14.0	8.0	8.0	2.0	2.0
	B - C	14.0	8.0	8.0	2.5	2.5

#### Ordering Instructions

**PS - 06 - P**

